

# SilkBio-100TC

## Multi-Bio Time Attendance & Access Control Terminal



SilkBio-100TC is the first ever Time & Attendance and Access Control Terminal to be associated with SilkID fingerprint reader, face recognition and FRID card functions. With the new SilkID fingerprint reader, the operation remain stable under strong light source and high preciseness of verification of wet and rough fingers. With latest facial algorithm and the innovation features, Silkbio-100TC is bringing you the whole new experience.

---

## Features

- Multi-biometric fast verification
- Stable operation under strong light source
- Infrared auto-turning on function to save power
- Quick recognition of dry, wet and rough fingers
- Multi-language supported
- Built-in 2000mAh backup battery to extend operation time
- Prevents duplicated face registration and supports fake face detection function

# Specifications

Face Capacity	800
Fingerprint Capacity	1500
ID Card Capacity	2,000 (Optional)
Record Capacity	100,000
Display	2.8-inch TFT Screen
Communication	RS232/485, TCP/IP, USB -Host
Standard Functions	Work Code, SMS, DST, Scheduled-bell, Self-Service Query, Automatic Status Switch ,Photo ID, T9 Input, Camera, 9 digit user ID, Built-in Battery, Multiple Verify Mode, External Bell.
Access Control Interface for	Lock, Door Sensor, Exit Button, Alarm
Wiegand Signal	Output
Optional Functions	ID/Mifare, ADMS
Power Supply	DC 12V 3A
Operating Temp.	0 °C- 45 °C
Operating Humidity	20%-80%
Dimension	173.0×159.0×36.1mm (Length×Width×Thickness)
Net Weight	490 g

## Configuration

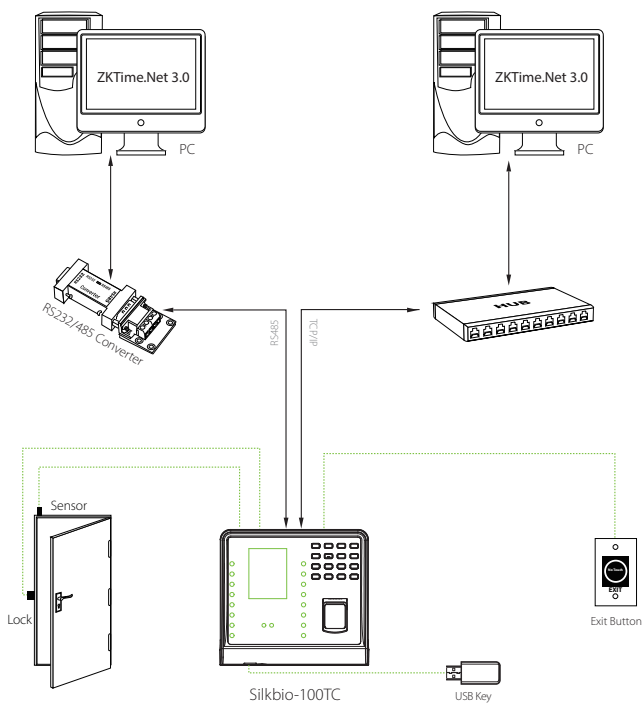

## Dimensions

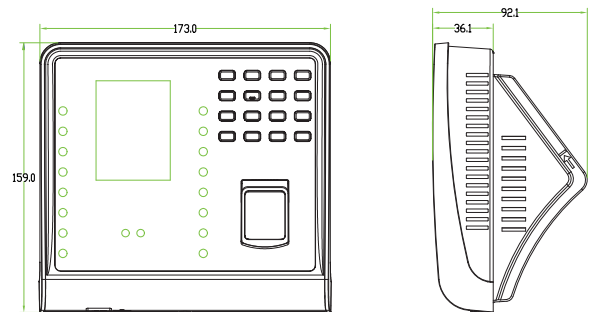

## Interface

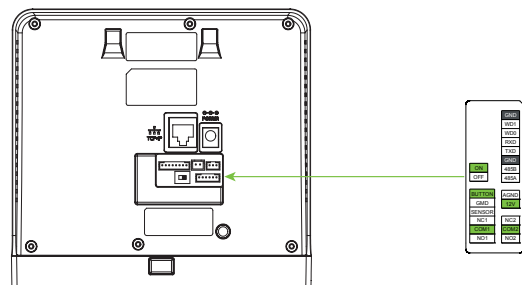

ZKTeco Inc.  
E-mail: sales@zkteco.com  
www.zkteco.com

© Copyright 2015. ZKTeco Inc. ZKTeco Logo is a registered trademark of ZKTeco or a related company. All other product and company names mentioned are used for identification purposes only and may be the trademarks of their respective owners. All specifications are subject to change without notice. All rights reserved.